

IBM40

Unità di bloccaggio UNIVERSAL



I	B	M	4	0	V	E	E
1	2	3	4	5	6		

1 Serie	2 Versione	3 Taglia
<p>IB = Unità di bloccaggio UNIVERSAL con regolazione continua angolo d'apertura da: 0° a 125° Max intercambiabile con Ø 50 e 63 mm</p> <p>L'angolo di apertura può variare a seconda della posizione e della tipologia del pressore</p>	<p>M = Pneumatica con leva manuale</p>	<p>40 = Ø 40 mm</p>
4 Posizione pressore	5 Tipo di pressore	6 Sensore di posizione
<p>V = 90° O = 180° N = Senza pressore</p>	<p>C = Centrale, offset 15 mm (standard) D = Destro, offset 15 mm (standard) S = Sinistro, offset 15 mm (standard) E = Centrale, offset 45 mm F = Destro, offset 45 mm L = Sinistro, offset 45 mm N = Senza pressore</p>	<p>N = Senza sensore (con piastra di chiusura) E = Sensore elettronico con connettore M12 orientabile</p>

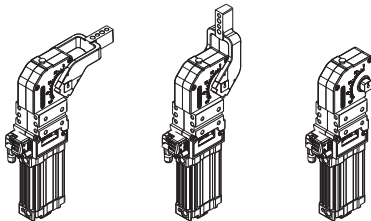

UNIVERSAL Pneumatic power clamp Ø50 / Ø63 mm sizes compatible

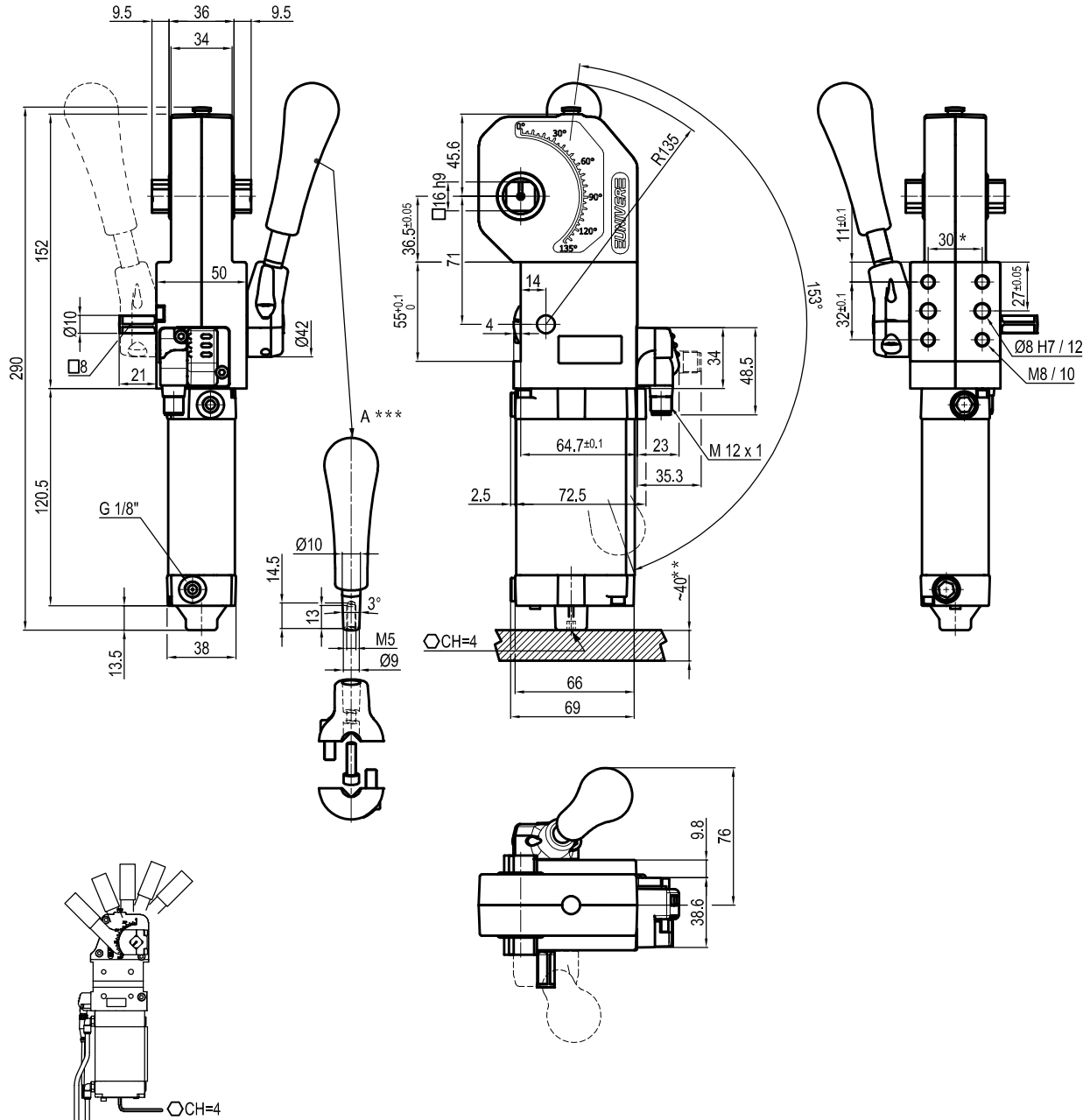

Bore Ø	Holding moment	Clamping moment (0.5 MPa)	Weight (Clamping arm not included)
40 mm	600 Nm	170 Nm	2.1 Kg

Min./Max. operating pressure: **0,4 / 0,6 MPa**

Operating temperature: **5° ± 45° C**

Opening angle: **adjustable**

Without arm

Electronic sensor with M12 swivel connector that can be orientated at 0° or 90°

Supply voltage: 10÷30 Vdc

IP code: **IP 65**

Pneumatic ports on both sides

* : TOLERANCE BETWEEN DOWELS ± 0.02, TO SCREW HOLES ± 0.1

** : AREA TO ACCESS ANGLE ADJUSTMENT

*** : DIMENSIONS TO BE RESPECTED IN CASE OTHER MANUAL LEVERS ARE USED

Subject to technical modification without notice.

UNIVERSAL Pneumatic power clamp Ø50 / Ø63 mm sizes compatible

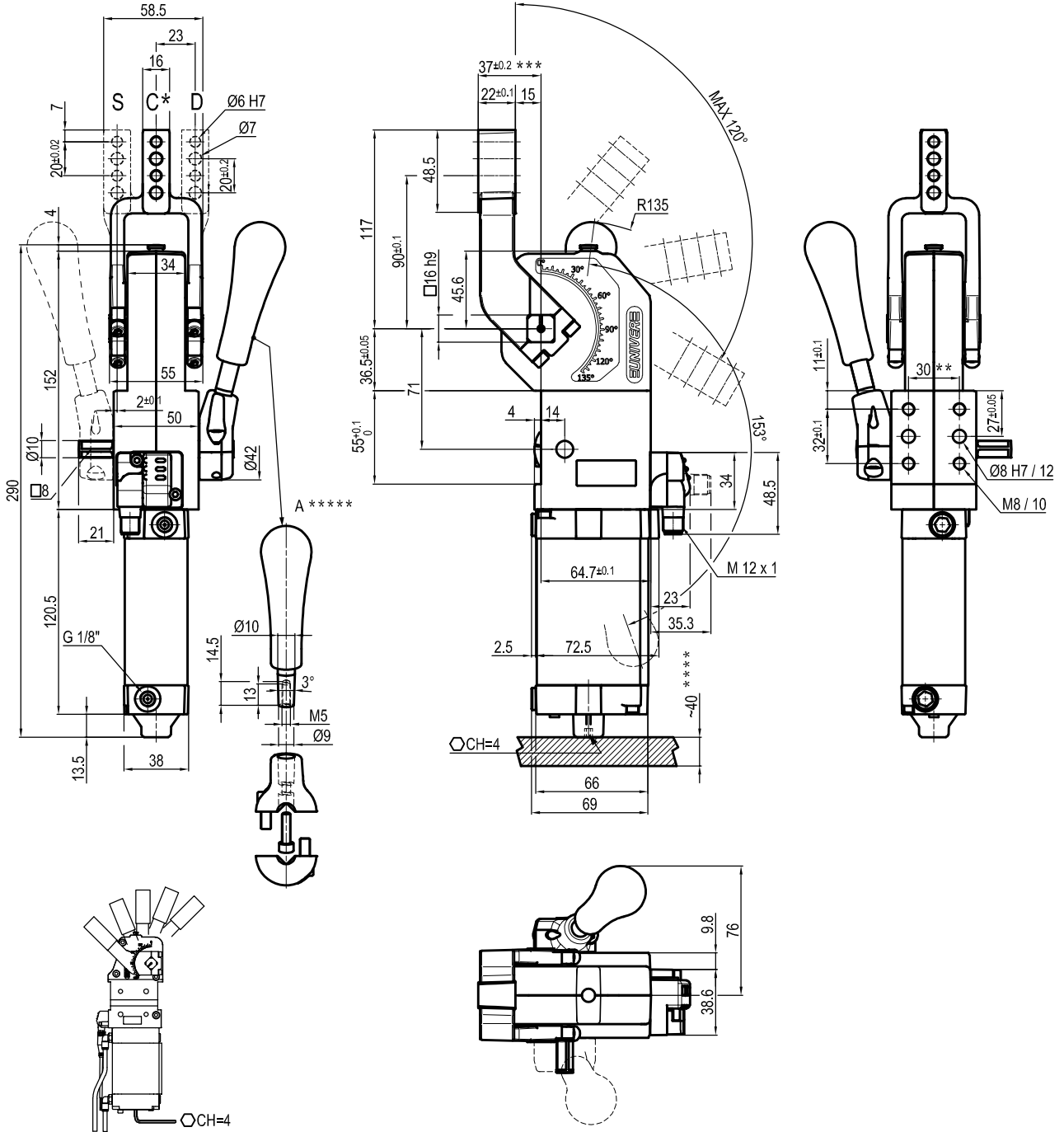

Bore Ø	Holding moment	Clamping moment (0.5 MPa)	Weight (Clamping arm not included)
40 mm	600 Nm	170 Nm	2.1 Kg

Min./Max. operating pressure: **0,4 / 0,6 MPa**
 Operating temperature: **5° ± 45° C**
 Opening angle: **adjustable from 0° to 120°**
 Horizontal arm mount position
 Electronic sensor with M12 swivel connector that can be orientated at 0° or 90°
 Supply voltage: 10±30 Vdc
 IP code: **IP 65**
 Pneumatic ports on both sides

* : "E" Ø50 / Ø63 mm SIZES COMPATIBLE
 ** : TOLERANCE BETWEEN DOWELS ± 0.02, TO SCREW HOLES ± 0.1
 *** : TOLERANCE AT 80 mm FROM PIVOT POINT
 **** : AREA TO ACCESS ANGLE ADJUSTMENT
 ***** : DIMENSIONS TO BE RESPECTED IN CASE OTHER LMANUAL LEVERS ARE USED

Subject to technical modification without notice.

UNIVERSAL Pneumatic power clamp with manual lever arm at 45 mm from pivot point (arm style E-L-F)

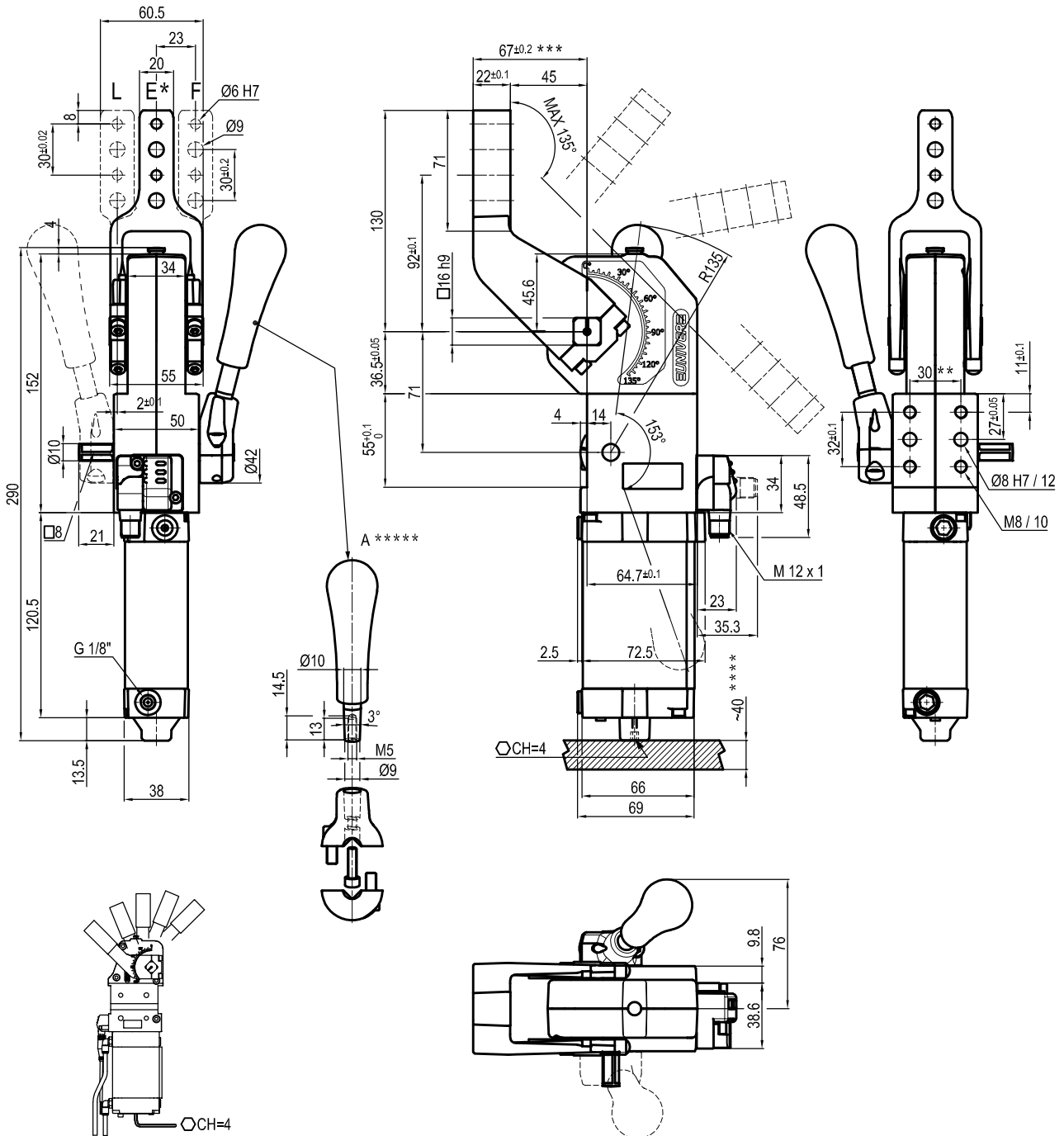

Bore Ø	Holding moment	Clamping moment (0.5 MPa)	Weight (Clamping arm not included)
40 mm	600 Nm	170 Nm	2.1 Kg

Min./Max. operating pressure: **0,4 / 0,6 MPa**
 Operating temperature: **5° ± 45° C**
 Opening angle: **adjustable from 0° to 135°**
 Horizontal arm mount position
 Electronic sensor with M12 swivel connector that can be orientated at 0° or 90°
 Supply voltage: 10±30 Vdc
 IP code: **IP 65**
 Pneumatic ports on both sides

* : "E" CENTRAL - Ø50 / Ø63 mm SIZES COMPATIBLE
 ** : TOLERANCE BETWEEN DOWELS ± 0.02, TO SCREW HOLES ± 0.1
 *** : TOLERANCE AT 80 mm FROM PIVOT POINT
 ***** : AREA TO ACCESS ANGLE ADJUSTMENT

Subject to technical modification without notice.

UNIVERSAL Pneumatic power clamp Ø50 / Ø63 mm sizes compatible

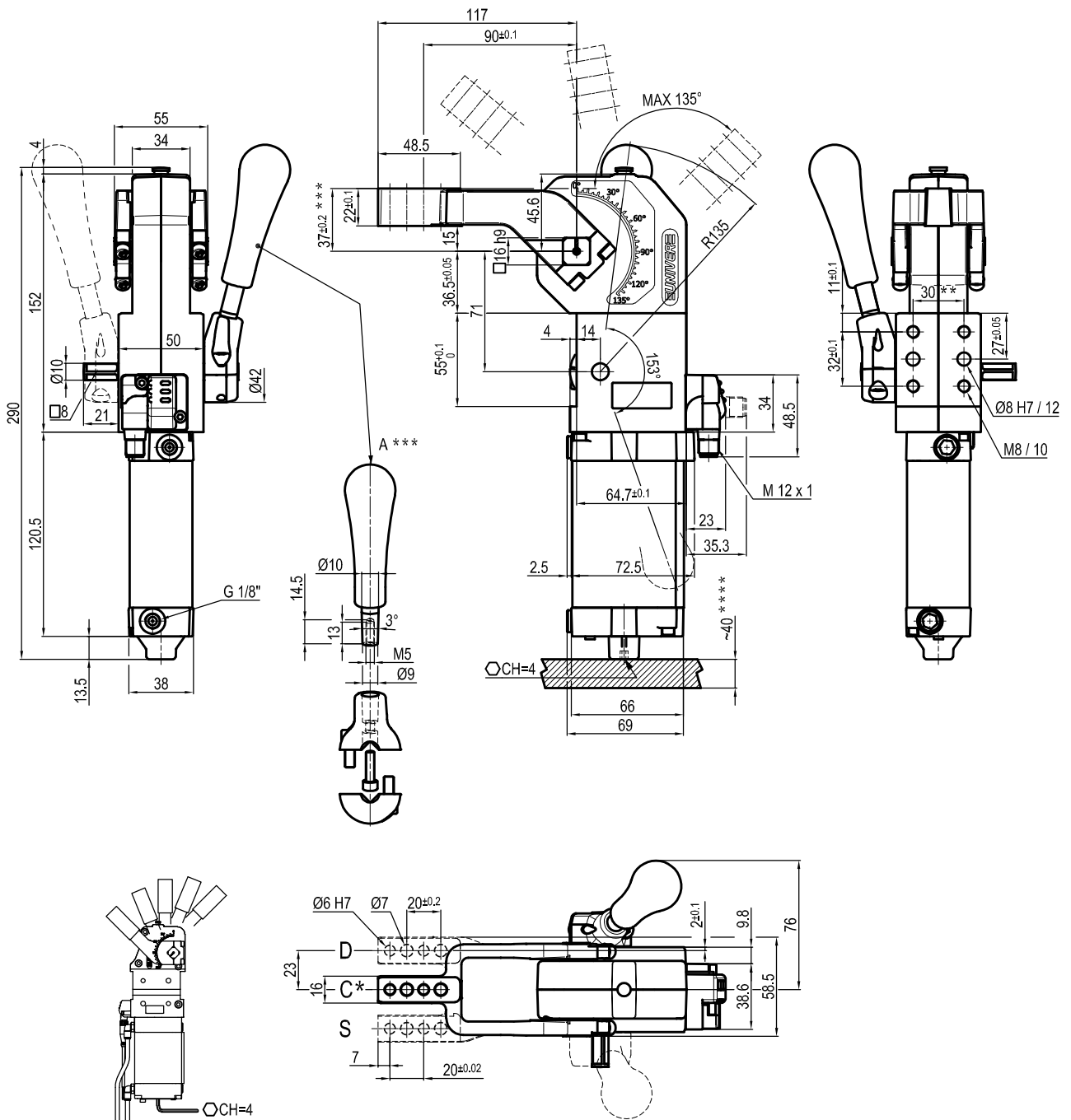

Bore Ø	Holding moment	Clamping moment (0.5 MPa)	Weight (Clamping arm not included)
40 mm	600 Nm	170 Nm	2.1 Kg

Min./Max. operating pressure: **0,4 / 0,6 MPa**
 Operating temperature: **5° ± 45° C**
 Opening angle: **adjustable from 0° to 135°**
 Vertical arm mount position
 Electronic sensor with M12 swivel connector that can be orientated at 0° or 90°
 Supply voltage: 10±30 Vdc
 IP code: **IP 65**
 Pneumatic ports on both sides

* : "E" CENTRAL - Ø50 / Ø63 mm SIZES COMPATIBLE
 ** : TOLERANCE BETWEEN DOWELS ± 0.02, TO SCREW HOLES ± 0.1
 *** : TOLERANCE AT 80 mm FROM PIVOT POINT
 **** : AREA TO ACCESS ANGLE ADJUSTMENT

Subject to technical modification without notice.

UNIVERSAL Pneumatic power clamp with manual lever arm at 45 mm from pivot point (arm style E-L-F)

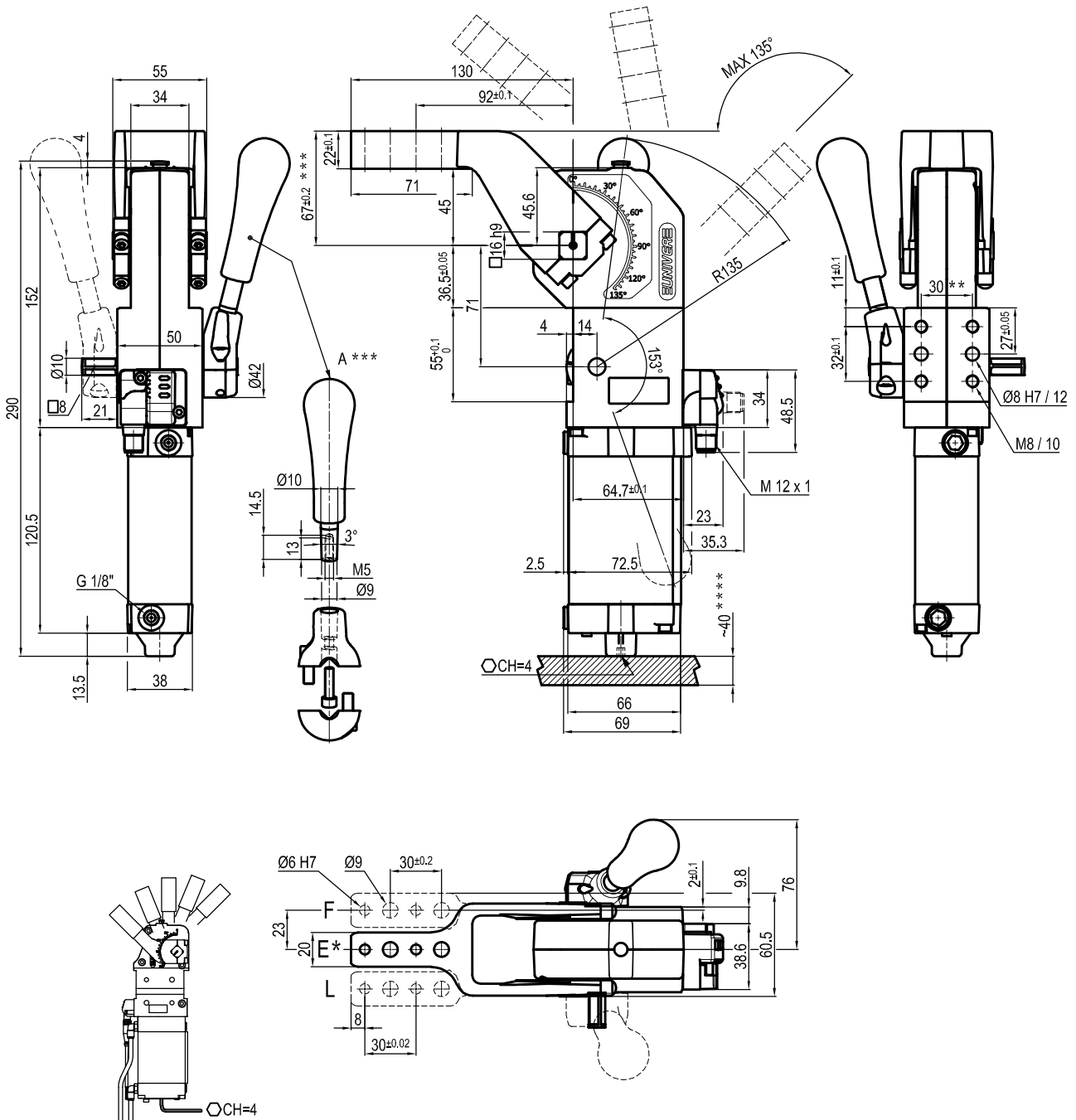

Bore Ø	Holding moment	Clamping moment (0.5 MPa)	Weight (Clamping arm not included)
40 mm	600 Nm	170 Nm	2.1 Kg

Min./Max. operating pressure: **0,4 / 0,6 MPa**

Operating temperature: **5° ± 45° C**

Opening angle: **adjustable from 0° to 135°**

Vertical arm mount position

Electronic sensor with M12 swivel connector that can be orientated at 0° or 90°

Supply voltage: 10±30 Vdc

IP code: **IP 65**

Pneumatic ports on both sides

* : "E" CENTRAL - Ø50 / Ø63 mm SIZES COMPATIBLE

** : TOLERANCE BETWEEN DOWELS ± 0.02, TO SCREW HOLES ± 0.1

*** : TOLERANCE AT 80 mm FROM PIVOT POINT

**** : AREA TO ACCESS ANGLE ADJUSTMENT

Subject to technical modification without notice.