

# UBP80

Unità di bloccaggio UNIVERSAL



U	B	P	8	0	N	N	E
1	2	3	4	5	6		

1 Serie	2 Versione	3 Taglia
<b>UB</b> = Unità di bloccaggio <b>UNIVERSAL</b> con regolazione continua angolo d'apertura da: <b>0° a 135° Max</b> L'angolo di apertura può variare a seconda della posizione e della tipologia del pressore	<b>P</b> = Pneumatica standard	<b>80</b> = Ø 80 mm

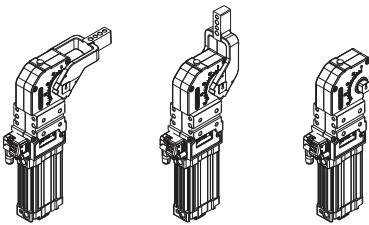
4 Posizione pressore	5 Tipo di pressore	6 Sensore di posizione
<b>V</b> = 90° <b>O</b> = 180° <b>N</b> = Senza pressore 	<b>C</b> = Centrale, 20 mm offset <b>D</b> = Destro, 20 mm offset <b>S</b> = Sinistro, 20 mm offset <b>E</b> = Centrale, 45 mm offset <b>F</b> = Destro, 45 mm offset <b>L</b> = Sinistro, 45 mm offset <b>N</b> = Senza pressore <b>X</b> = Centrale con fori maggiorati Ø 8 H7, 20 mm offset <b>Y</b> = Destro con fori maggiorati Ø H7, 20 mm offset <b>Z</b> = Sinistro con fori maggiorati Ø 8 H7, 20 mm offset	<b>N</b> = Senza sensore (con piastra di chiusura) <b>E</b> = Sensore elettronico con connettore M12 orientabile

**Disponibile versione doppio pressore  
UBP80ODPE - UBP80VDPE**

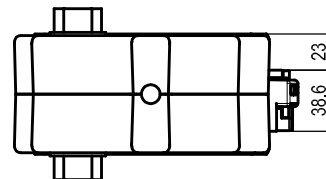
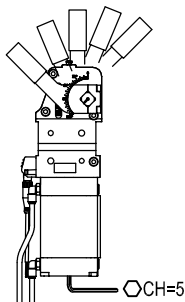
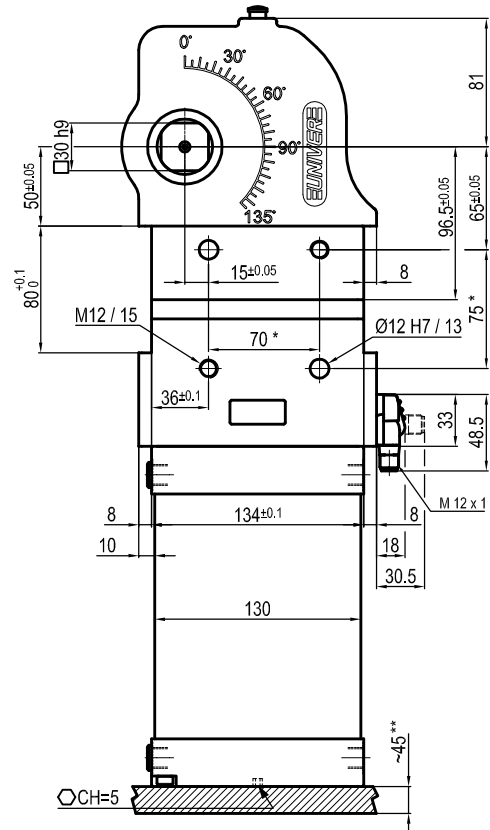
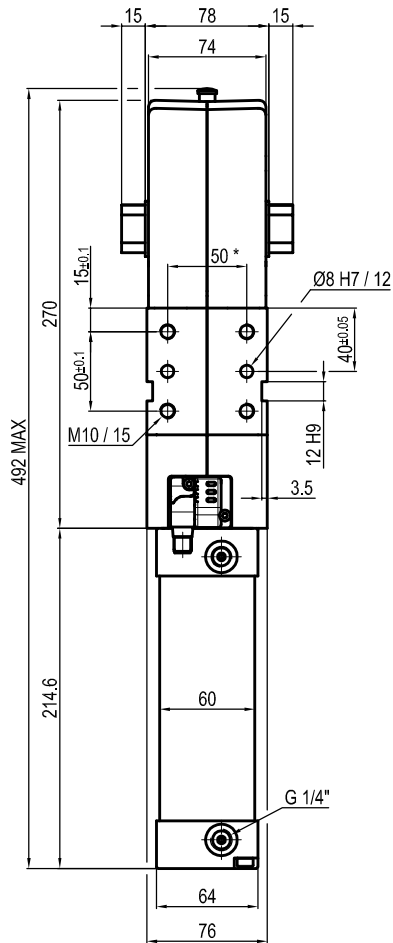

Bore Ø	Holding moment	Clamping moment (0.5 MPa)	Weight (Clamping arm not included)
80 mm	4000 Nm	1100 Nm	9.3 Kg

Min./Max. operating pressure: **0,4 / 0,6 MPa**

Operating temperature: **5° + 45° C**

Opening angle: **adjustable**

Without arm

Electronic sensor with M12 swivel connector that can be orientated at 0° or 90°

Supply voltage: 10÷30 Vdc

IP code: **IP 65**

Pneumatic ports on both sides

\* : TOLERANCE BETWEEN DOWELS ± 0.02, TO SCREW HOLES ± 0.1

\*\* : AREA TO ACCES ANGLE ADJUSTMENT

Subject to technical modifications without notice

## UNIVERSAL Pneumatic clamp

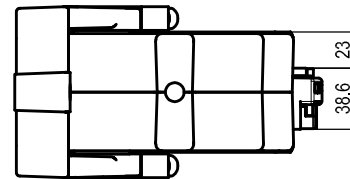
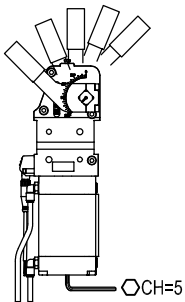
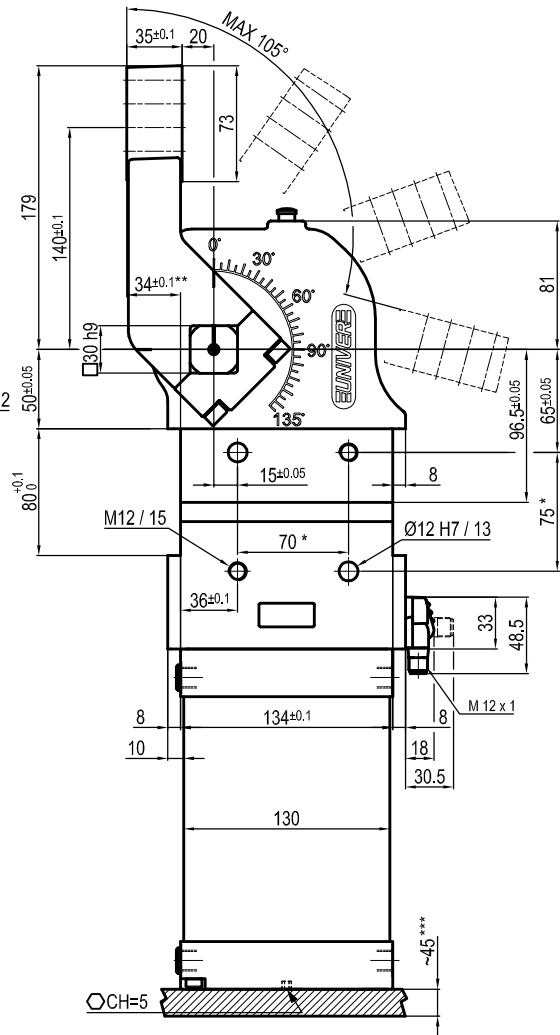
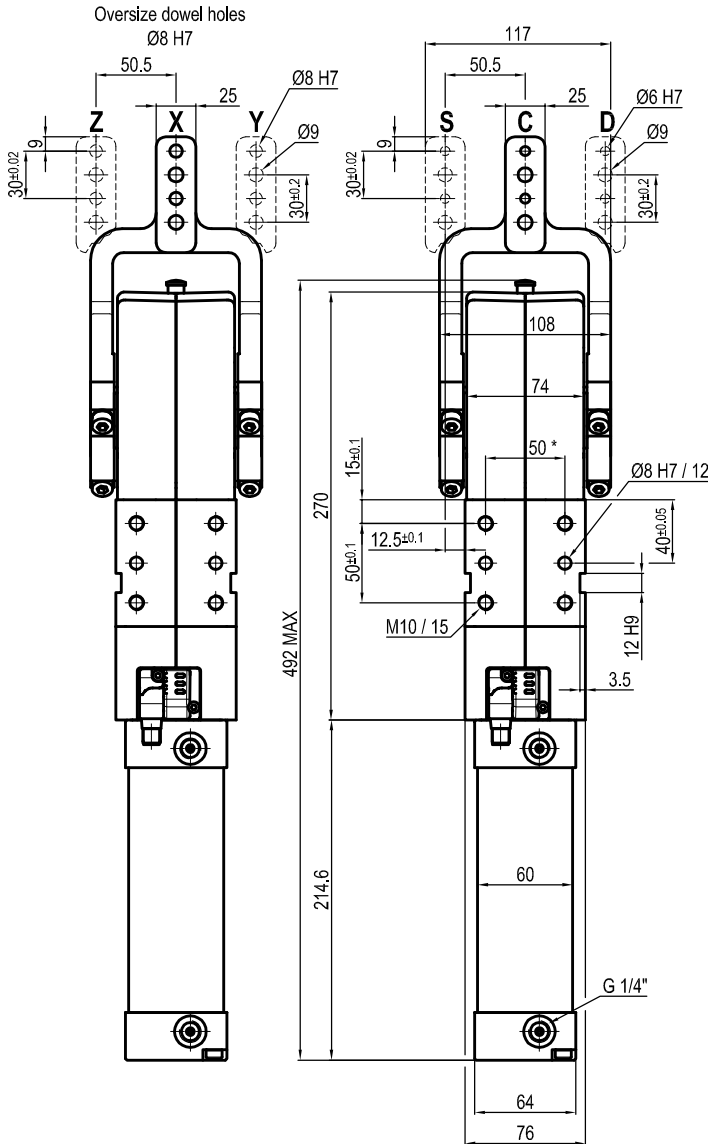

Bore Ø	Holding moment	Clamping moment (0.5 MPa)	Weight (Clamping arm not included)
80 mm	4000 Nm	1100 Nm	9.3 Kg

Min./Max. operating pressure: **0,4 / 0,6 MPa**  
 Operating temperature: **5° + 45° C**  
 Opening angle: **adjustable from 0° to 105°**  
 Horizontal arm mount position  
 Electronic sensor with M12 swivel connector that can be orientated at 0° or 90°  
 Supply voltage: 10÷30 Vdc  
 IP code: **IP 65**  
 Pneumatic ports on both sides

\* : TOLERANCE BETWEEN DOWELS ± 0.02, TO SCREW HOLES ± 0.1  
 \*\* : TOLERANCE AT 80 mm FROM PIVOT POINT  
 \*\*\* : AREA TO ACCESS ANGLE ADJUSTMENT.

Subject to technical modifications without notice

## UNIVERSAL Pneumatic clamp

arm at 45 mm from pivot point ( arm style E-L-F )

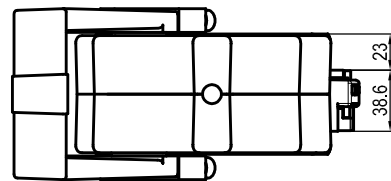
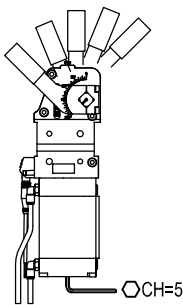
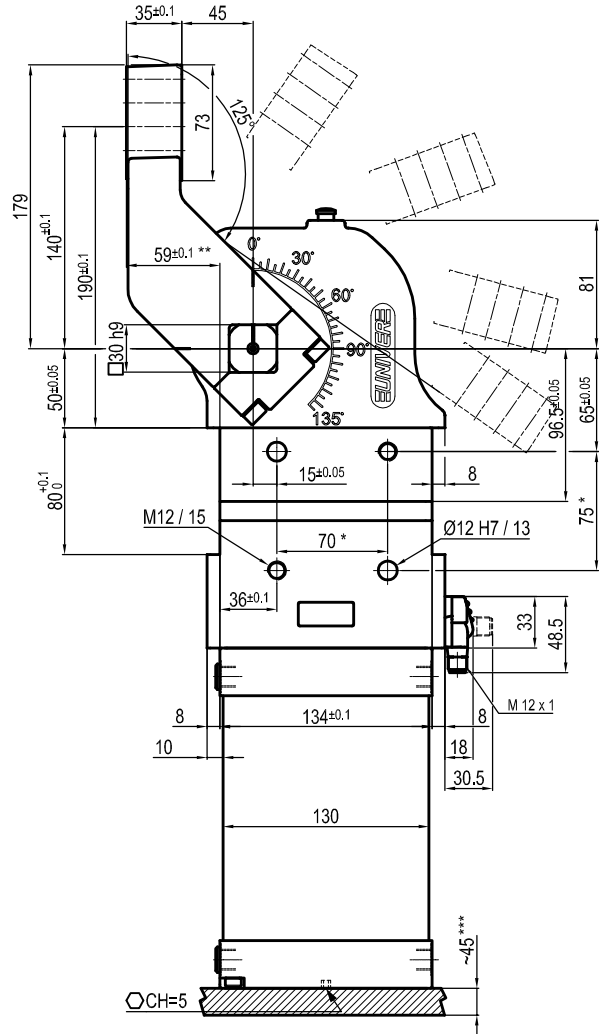
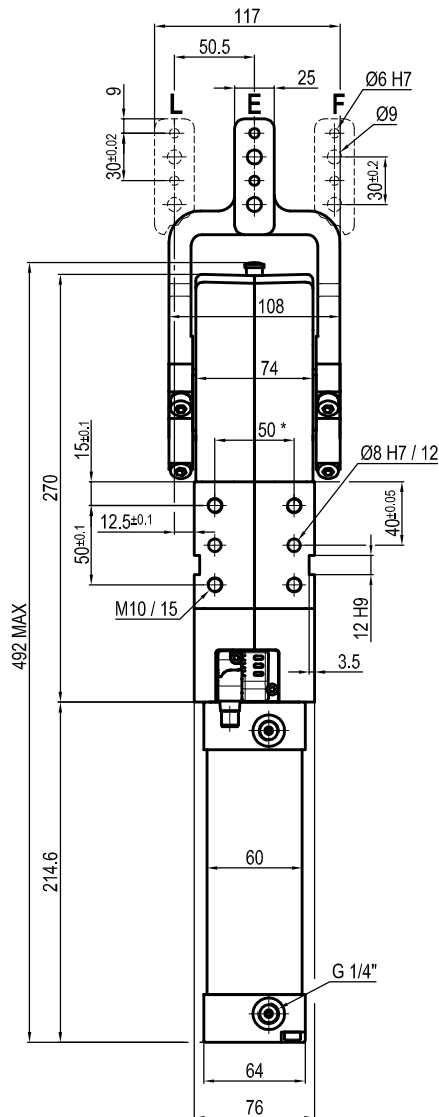

Bore Ø	Holding moment	Clamping moment (0.5 MPa)	Weight (Clamping arm not included)
80 mm	4000 Nm	1100 Nm	9.3 Kg

Min./Max. operating pressure: **0,4 / 0,6 MPa**  
 Operating temperature: **5° + 45° C**  
 Opening angle: **adjustable from 0° to 125°**  
 Horizontal arm mount position  
 Electronic sensor with M12 swivel connector that can be orientated at 0° or 90°  
 Supply voltage: 10±30 Vdc  
 IP code: **IP 65**  
 Pneumatic ports on both sides

\* : TOLERANCE BETWEEN DOWELS ± 0.02, TO SCREW HOLES ± 0.1  
 \*\* : TOLERANCE AT 80 mm FROM PIVOT POINT  
 \*\*\* : AREA TO ACCES ANGLE ADJUSTMENT

Subject to technical modifications without notice



## UNIVERSAL Pneumatic clamp

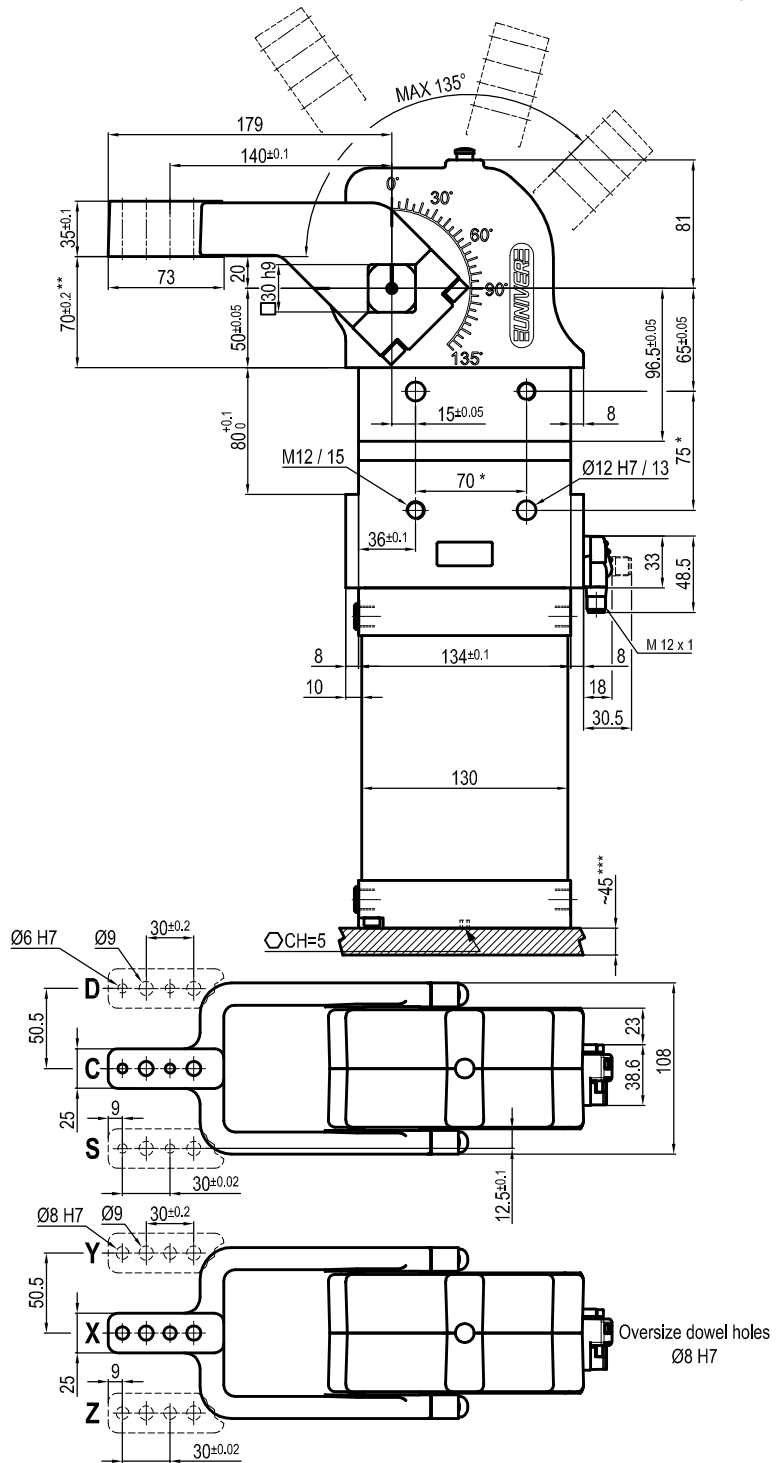
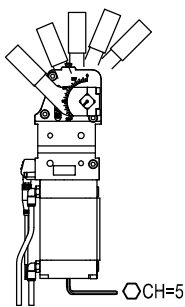
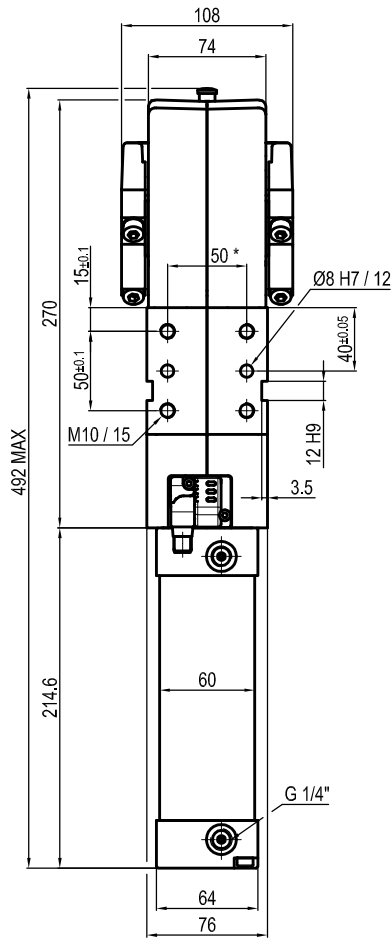

Bore Ø	Holding moment	Clamping moment (0.5 MPa)	Weight (Clamping arm not included)
80 mm	4000 Nm	1100 Nm	9.3 Kg

Min./Max. operating pressure: **0,4 / 0,6 MPa**

Operating temperature: **5° + 45° C**

Opening angle: **adjustable from 0° to 135°**

Vertical arm mount position

Electronic sensor with M12 swivel connector that can be orientated at 0° or 90°

Supply voltage: 10÷30 Vdc

IP code: **IP 65**

Pneumatic ports on both sides

\* : TOLERANCE BETWEEN DOWELS ± 0.02, TO SCREW HOLES ± 0.1

\*\* : TOLERANCE AT 80 mm FROM PIVOT POINT

\*\*\* : AREA TO ACCESS ANGLE ADJUSTMENT.

Subject to technical modifications without notice

## UNIVERSAL Pneumatic clamp arm at 45 mm from pivot point ( arm style E-L-F)

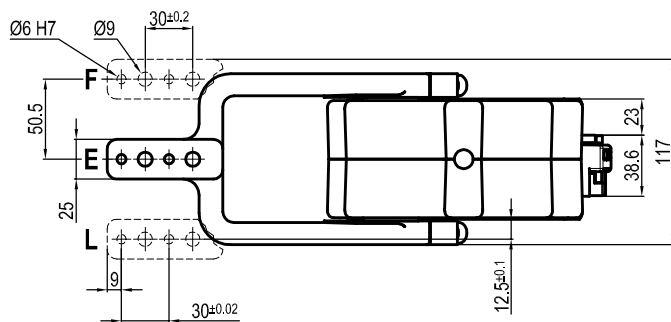
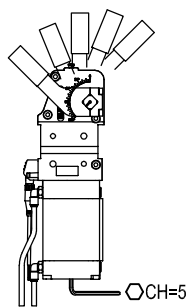
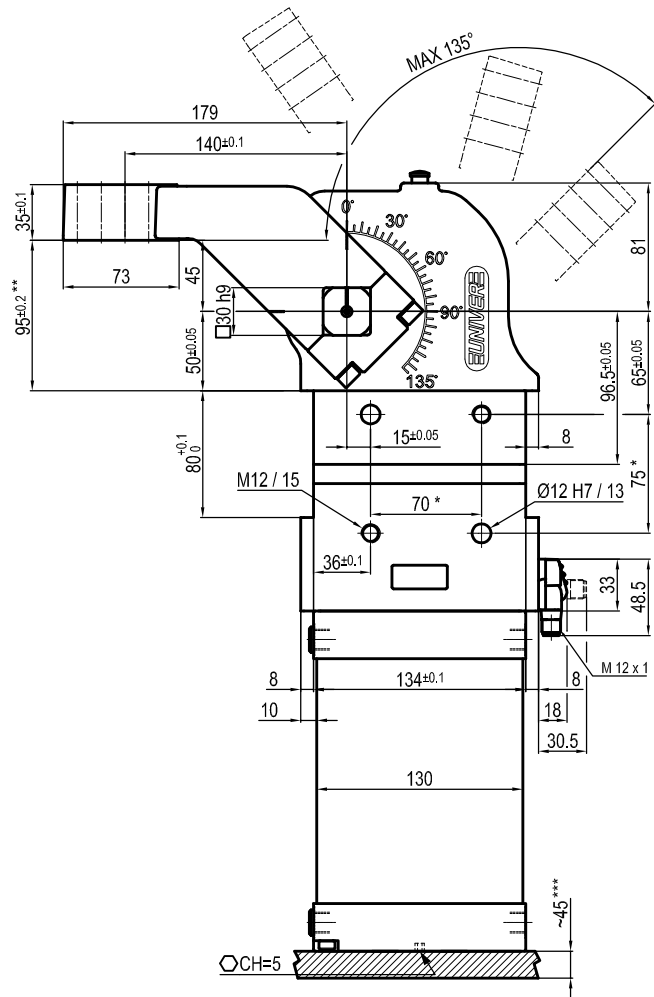
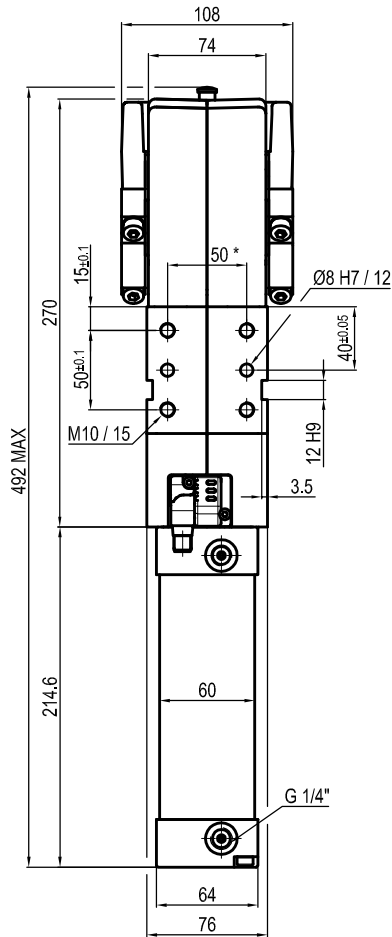

Bore Ø	Holding moment	Clamping moment (0.5MPa)	Weight (Clamping arm not included)
80 mm	4000 Nm	1100 Nm	9.3 Kg

Min./Max. operating pressure: **0,4 / 0,6 MPa**  
 Operating temperature: **5° + 45° C**  
 Opening angle: **adjustable from 0° to 135°**  
 Vertical arm mount position  
 Electronic sensor with M12 swivel connector that can be orientated at 0° or 90°  
 Supply voltage: 10÷30 Vdc  
 IP code: **IP 65**  
 Pneumatic ports on both sides

\* : TOLERANCE BETWEEN DOWELS ± 0.02, TO SCREW HOLES ± 0.1  
 \*\* : TOLERANCE AT 80 mm FROM PIVOT POINT  
 \*\*\* : AREA TO ACCES ANGLE ADJUSTMENT

Subject to technical modifications without notice

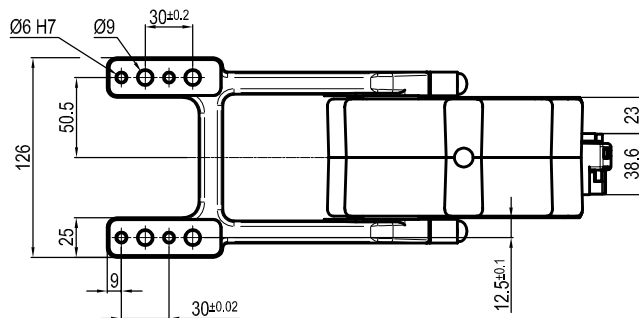
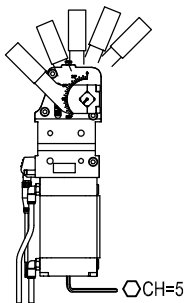
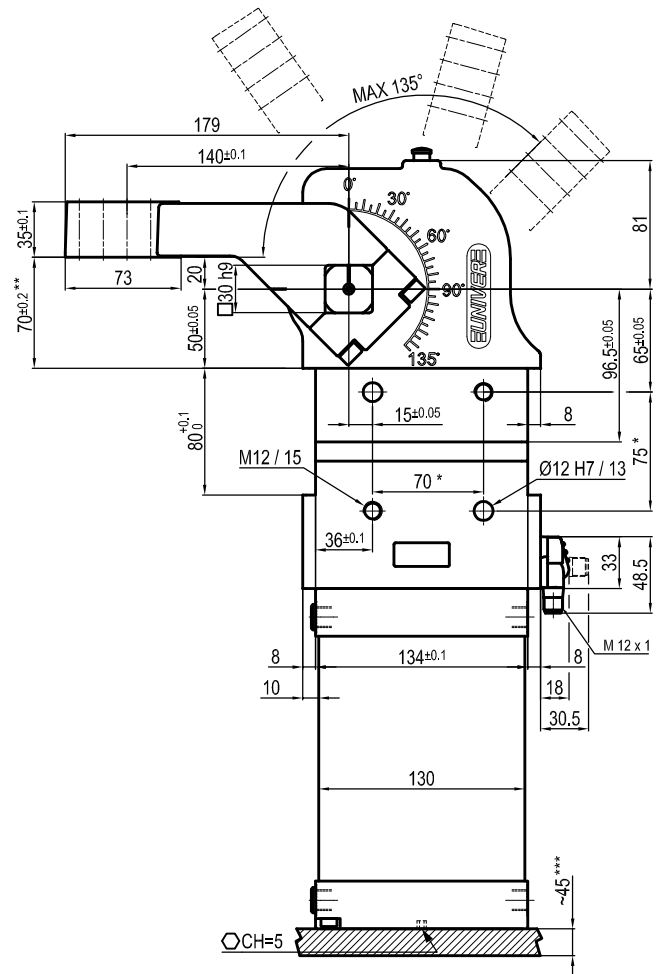
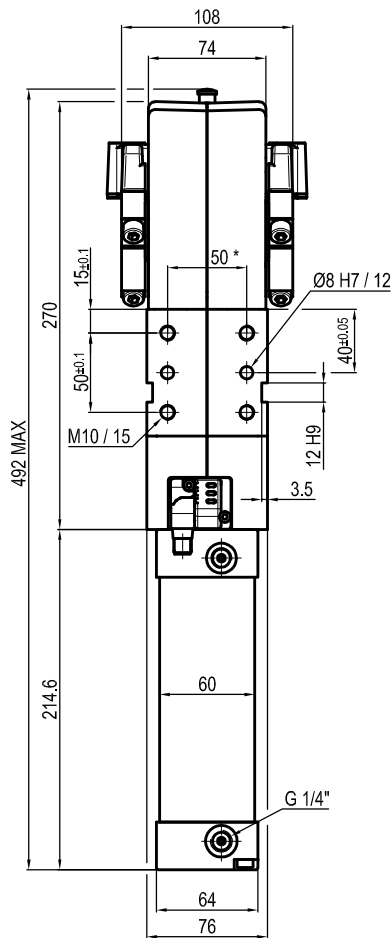

Bore Ø	Holding moment	Clamping moment (0.5 MPa)	Weight (Clamping arm not included)
80 mm	4000 Nm	1100 Nm	9.3 Kg

Min./Max. operating pressure: **0,4 / 0,6 MPa**

Operating temperature: **5° + 45° C**

Opening angle: **adjustable from 0° to 135°**

Vertical arm mount position

Electronic sensor with M12 swivel connector that can be orientated at 0° or 90°

Supply voltage: 10÷30 Vdc

IP code: **IP 65**

Pneumatic ports on both sides

\* : TOLERANCE BETWEEN DOWELS ± 0.02, TO SCREW HOLES ± 0.1

\*\* : TOLERANCE AT 80 mm FROM PIVOT POINT

\*\*\* : AREA TO ACCESS ANGLE ADJUSTMENT.

Subject to technical modifications without notice